

# AIPHONE

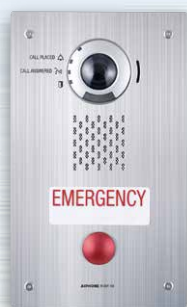

SYSTEM

IP Video Intercom System





# Providing a Smart IP Intercom for Security, Convenience, and Efficiency in Any Facility

Smooth communication and high security for visitors, staff, and administrators are crucial for efficient facility operations. The IX System utilizes IP networking to provide stable video and audio communication, enabling seamless connectivity across large facilities and remote locations. Integration with the IXG system, flexible third-party device connectivity and advanced scalability enable the system to meet the needs of various industries and applications. Whether for small or large facilities, the IX System enhances security, streamlines operations, and improves overall facility management efficiency.

**Parking Lots**



**Transportation Infrastructures**

**Schools**



## ***APPLICATIONS***



**Access Control**



**Emergency Alert**



# Solution Operational

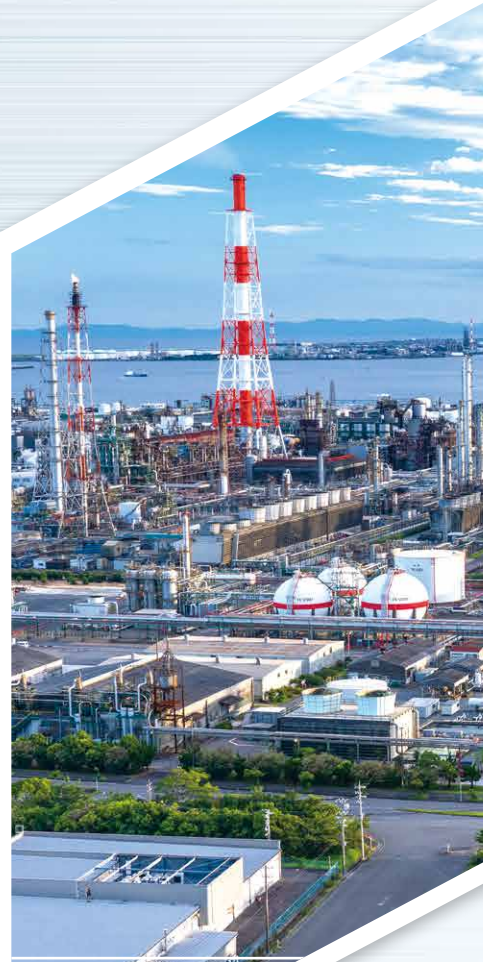

**Factories**



**Commercial Buildings**



**Offices**

## ***FACILITIES***

**Flexible  
System Design**

**Integration**

**Versatile  
Functionality**

**Flexible  
Communication**

**Video Enabled  
Security**

**Usability**



**Internal Communication**



**Video Surveillance**



**Centralized Management of Remote Location**

# Broad and Flexible System Design for Any Space

Full IP-network compatibility, simple installation, and excellent flexibility

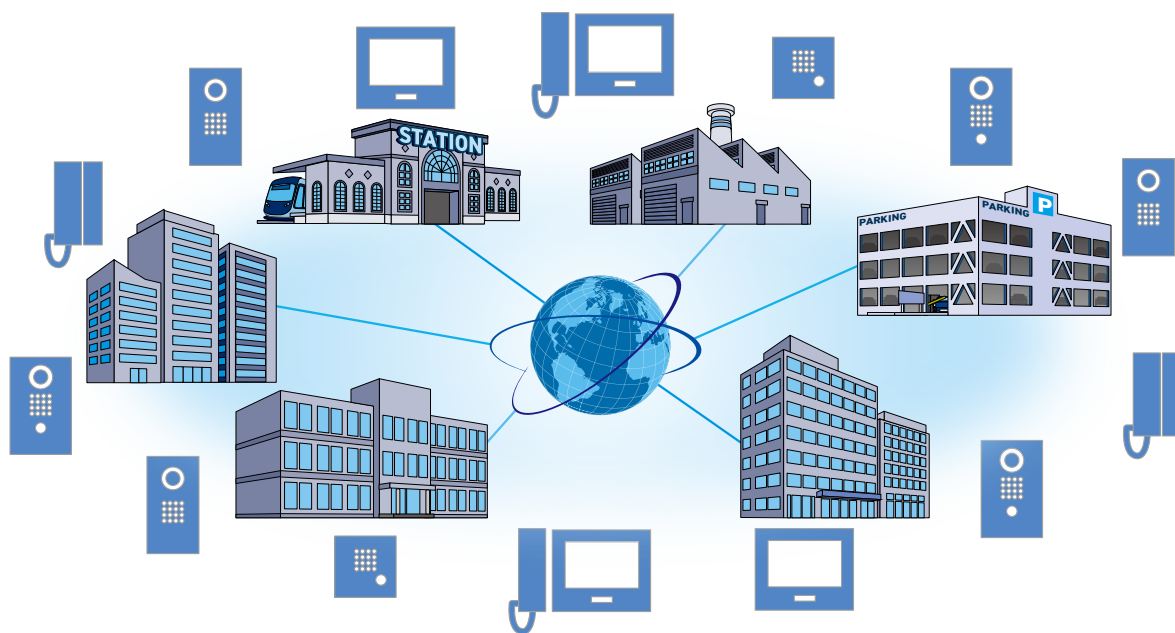

## ■ Extendable Network with No Distance or Device Limits

Up to 9,998 call addresses can be registered in IX master stations. Communication between devices supports both unicast and multicast. With extreme scalability, this solution is ideal for installations of any size. LAN and VPN connectivity enable seamless implementation across large areas and remote locations. This facilitates closed-circuit communication and central control for large facilities, corporate and satellite offices, and multi-site applications.

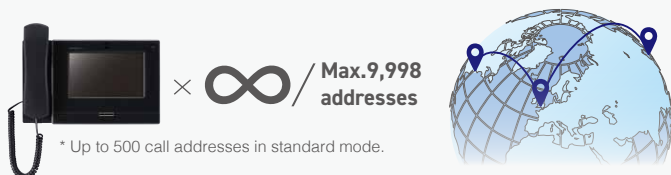

## ■ High Stability with Peer-to-peer Configuration

No dedicated server is required, minimizing the risk of system downtime due to server failure. This configuration also contributes to space savings, reduced installation time, and lower costs. Simply connect the units to Power over Ethernet (PoE) switches for easy setup.

### Peer-to-peer

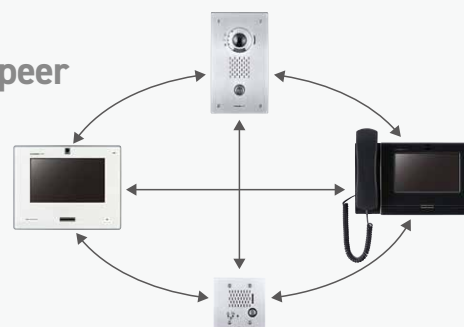

## ■ Wide Range of Product Variations

We offer a variety of devices with different sizes, installation methods, and features, ensuring compatibility with a wide range of installation environments and applications.



## ■ Compatibility with IP Video Door Entry System IXG

The system is compatible with the IP Video Door Entry System IXG, making it ideal for installation in mixed-use buildings that combine residential units, commercial facilities, and parking areas.

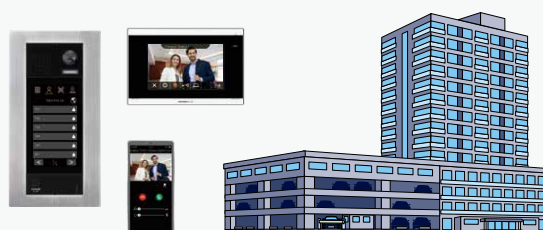



# Seamless Integration Designed to Meet User Demands

System integration enhances both security and convenience



## Compatible with IP Network Systems

With support for IP networks, the IX System enables the integration of third-party network products to create a unified IP system. It is fully compatible with the ONVIF Profile S interface specifications for network camera equipment. Additionally, the open API provides greater flexibility in configuring IP systems to meet specific needs.

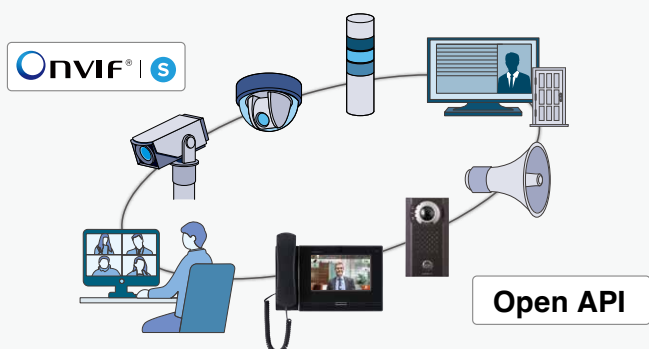

## Integration with IP-PBX Systems

IP-PBX integration allows the IX system to seamlessly integrate with your internal telephone network. Users can make and receive calls, answer visitor requests, and control door releases directly through the system.



\*Integration with CISCO system (CUCM), Avaya system (Office, Aura), Digium system (Switchvox), Alcatel-Lucent system (OXO, OXE), and Genetec system (Sipelia) is possible. For further details, please contact your dealer.

\*Some countries have local restrictions on connecting to a PBX. Please refer to our website (<https://www.aiphone.net/>) for information on countries where PBX connections are permitted.

## Conventional output and input contact

The stations are equipped with output and input contacts, as well as audio output terminals, enabling seamless integration with various devices. This enables functions such as unlocking electric locks, activating rotating lights, making calls by emergency buttons, and paging through external speakers.

### Output



### Input





# Smart, Secure, and Versatile Functionality for Every Need

## Flexible Communication

### Flexible Group Call Functionality

The system allows for both individual and group calls. You can select specific groups to call, and set priority levels to ensure that high-urgency calls are answered first.

#### Group calls (Master station)

Up to 50<sup>\*1</sup> or 99<sup>\*2</sup> groups can be registered.

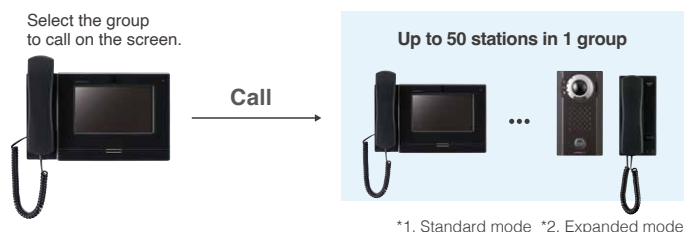

#### Group calls (Door station/Sub station)

Up to 10 groups can be registered.

Call preset groups. Groups can be switched according to preset schedules.

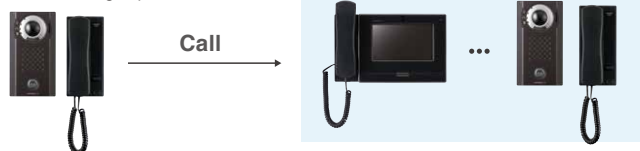

### Secure and Reliable Face-to-Face Communication

Master-to-master communication allows for face-to-face interaction from a distance while ensuring security and reliability. You can also use written communication and show objects or drawings for clearer and more effective explanations.

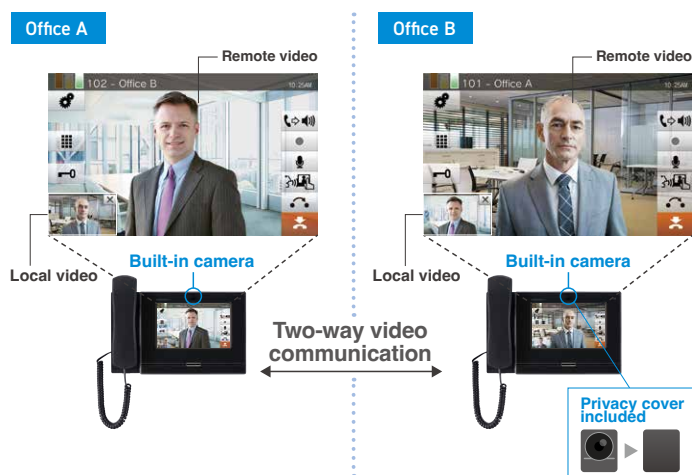

### Convenient Call Transfer for Unattended Situations

The system features a flexible call transfer function that ensures calls are handled without keeping callers waiting. When answering on-site is not possible, calls can be forwarded to a remote location, allowing for video verification and door release. This enhances remote site management capabilities.

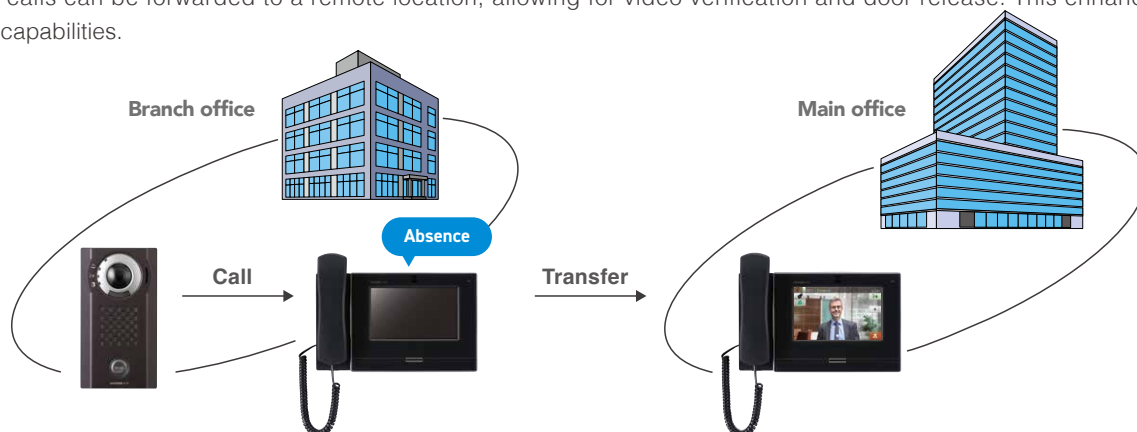

#### ● Absent transfer

One-touch setup enables automatic call transfer when temporarily away.

#### ● Scheduled transfer

Calls are transferred automatically based on time or day, such as outside business hours.

#### ● Delayed transfer

Calls are automatically transferred if there is no response within a set time.

#### ● Transfer

Calls can be put on hold and transferred to another device or group.

\*The first automatic transfer can forward calls to up to 10 stations simultaneously. \*A forwarded call can be transferred again to one additional station.

### Call Queuing

Master stations can receive up to 20 incoming calls simultaneously. Caller information is displayed on a call queue list, making it possible to respond selectively to high-priority calls.



A wide range of features that cater to all your security and communication needs.

## ■ Paging Functionality for Remote Locations

Paging to all<sup>\*1</sup> stations and specific preset groups are possible. In addition to on-site paging, remote announcements can also be made. This enables efficient operation by integrating the visitor management system with the facility-wide paging system.



### ● External audio source Paging

Paging can be performed by connecting an external audio device, such as a sound source unit.

### ● Paging

Answering by audio is available.

### ● Message Paging

Pre-recorded audio message, audio file, can be distributed to registered stations. Messages can also be played with a single touch using shortcut buttons or input contacts.

\*1. Up to 500 stations \*2. Standard mode \*3. Expanded mode

## ■ Seamless Communication Between PCs, Smartphones, and IX

Enjoy intercom functionality on your PC or smartphone without being limited to dedicated IX master stations installed in fixed locations.

### ● IX Intercom Application for PC

Achieve master station-level functionality directly from your PC.



\*1. Download the software from our website (<https://www.aiphone.net/>) to the PC.  
\*2. USB dongle must be connected to the PC while using the software.

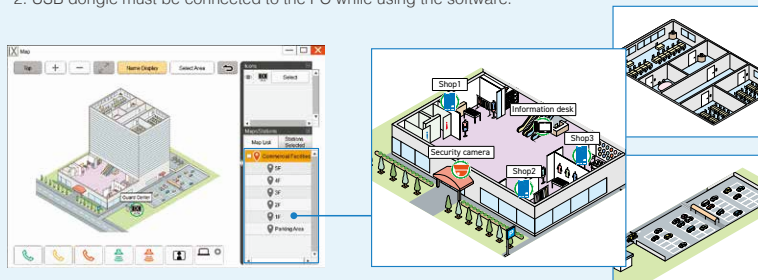

Interactive map provides a bird's eye view of the system's operation and status via station icons.

### ● Intercom App (Linked with IXG System)

Respond to calls from anywhere even when the security office is unmanned, using your smartphone during patrols.

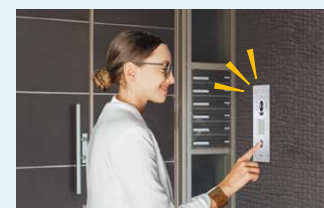

Entrance

Call

Communication

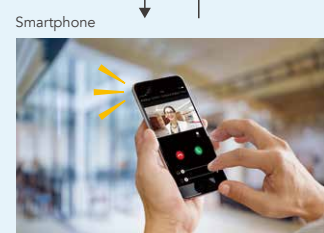

Smartphone



# Smart, Secure, and Versatile Functionality for Every Need

## Video-Enabled Security Solutions

### Visitor Identification with Network Camera Integration

Viewing different angles simultaneously - such as a front-facing image of the visitor and the surrounding environment - provides better situational awareness and enhances security.

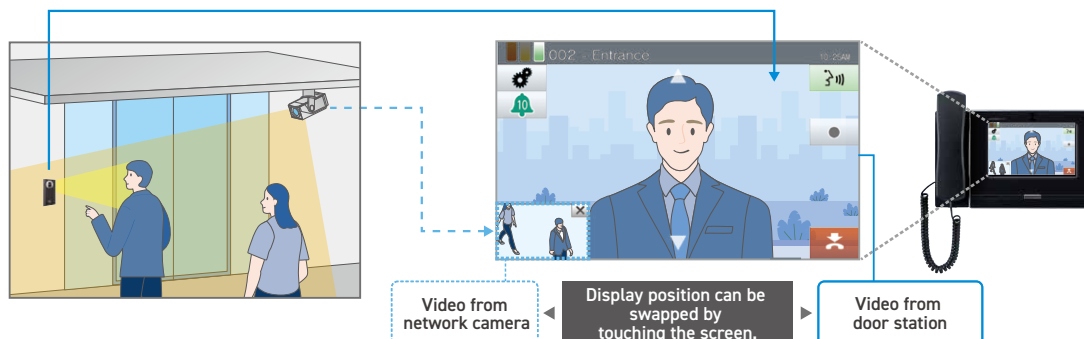

### Visitor Identification with Video and Recording

Master stations and video door stations are equipped with video and audio recording capabilities, enabling users to review footage of suspicious visitors later. During conversations, two-way audio is also recorded, enabling users to verify communication details afterward. Additionally, door stations support continuous video and audio recording, allowing them to function as standalone surveillance cameras.

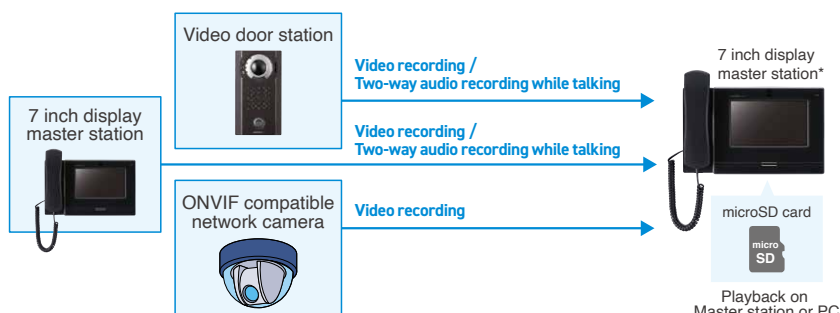

Recommended microSD card

model	Standard	Capacity	Speed Classes
Master station	SDHC	4GB to 32GB	C10
	SDXC	64GB to 128GB	C10, U1
Door station	SDHC	4GB to 32GB	C10

\* IX-RS-B, IX-RS-W, IX-SS-2G, IX-DB and IX-BB do not have a microSD slot for recording.

### Integration with Video Surveillance Systems

By integrating with third-party video surveillance systems, the intercom camera footage can be monitored and recorded continuously, just like network cameras. This enables seamless and comprehensive video surveillance.

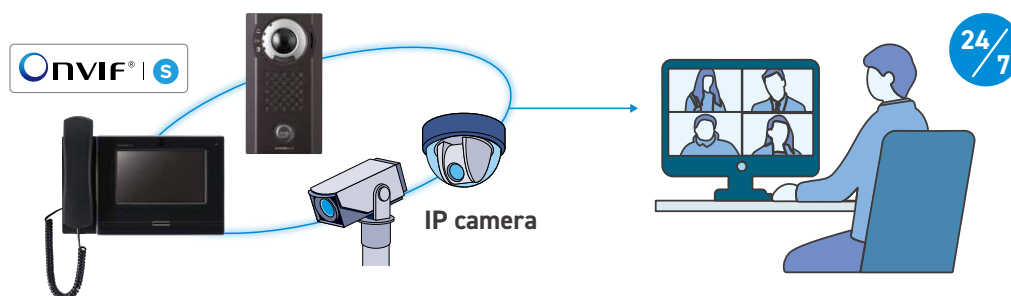

### Real-Time Monitoring

Monitor real-time video and audio from other stations and network cameras via the master station. Sequential monitoring of multiple stations is also available with the scan monitoring feature.

## Streamlined Operation with Speed Dial Buttons

By registering frequently used functions to Speed Dial Buttons, users can operate them with a single touch. Even those unfamiliar with the system can use it effortlessly.

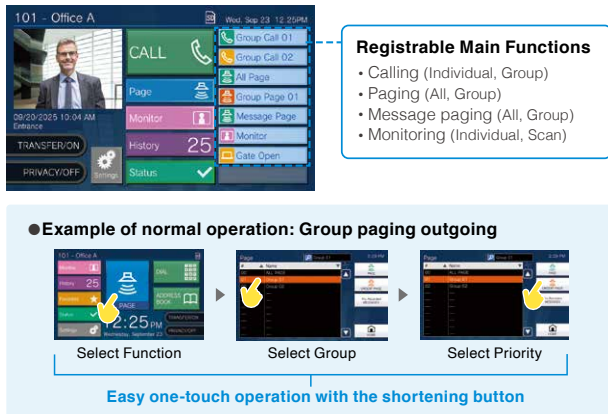

## Powerful and Clear Sound in All Situations

Conversations stay clear even in areas with background noise. Integrate with PA systems for enhanced flexibility and sound coverage.

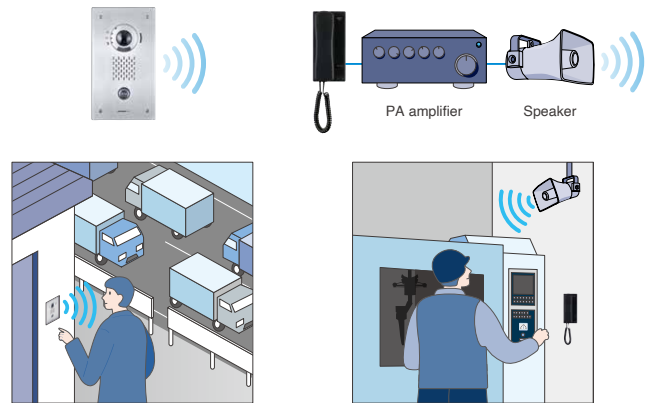

## Voice Messages for Call Notifications

Create and import custom audio files to use as unique voice messages. At door stations, voice messages inform visitors of door and communication statuses. At master stations, voice messages help security guards and reception staff quickly identify incoming calls and special situations.



## Notification of Call and Communication Status

Indicator lamps, along with sounds or voice messages, notify users of call and communication status, enhancing security and peace of mind.

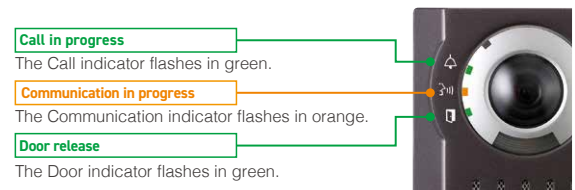

## Chime

Chimes can be scheduled individually for each device, allowing for customized alerts based on predefined schedules.

## Automatic System Status Supervision For Administrators

By using the IX Supervision Tool installed on a PC or master station, you can quickly and accurately detect line or station failures, ensuring system reliability. Email notifications can also be configured for failure alerts.

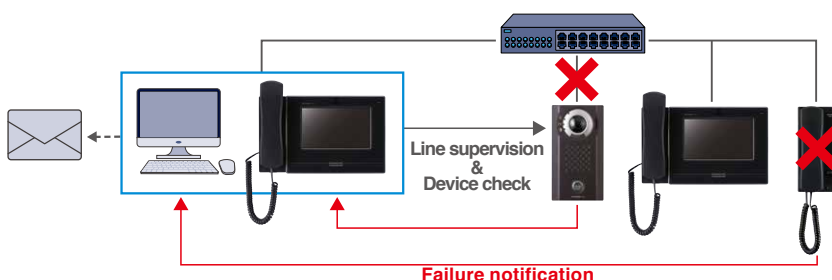

## Sending E-mail reports For Administrators

When master stations are called, the IX System can send an email with the visitor's picture attached to up to three email addresses. Error and device check reports can also be sent via email.

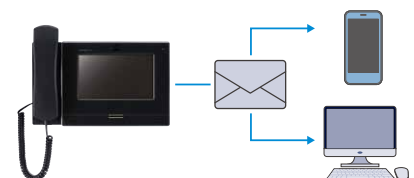



# Examples of Popular Applications

## Commercial facilities and offices

All-in-one system for internal communication and emergency assistance

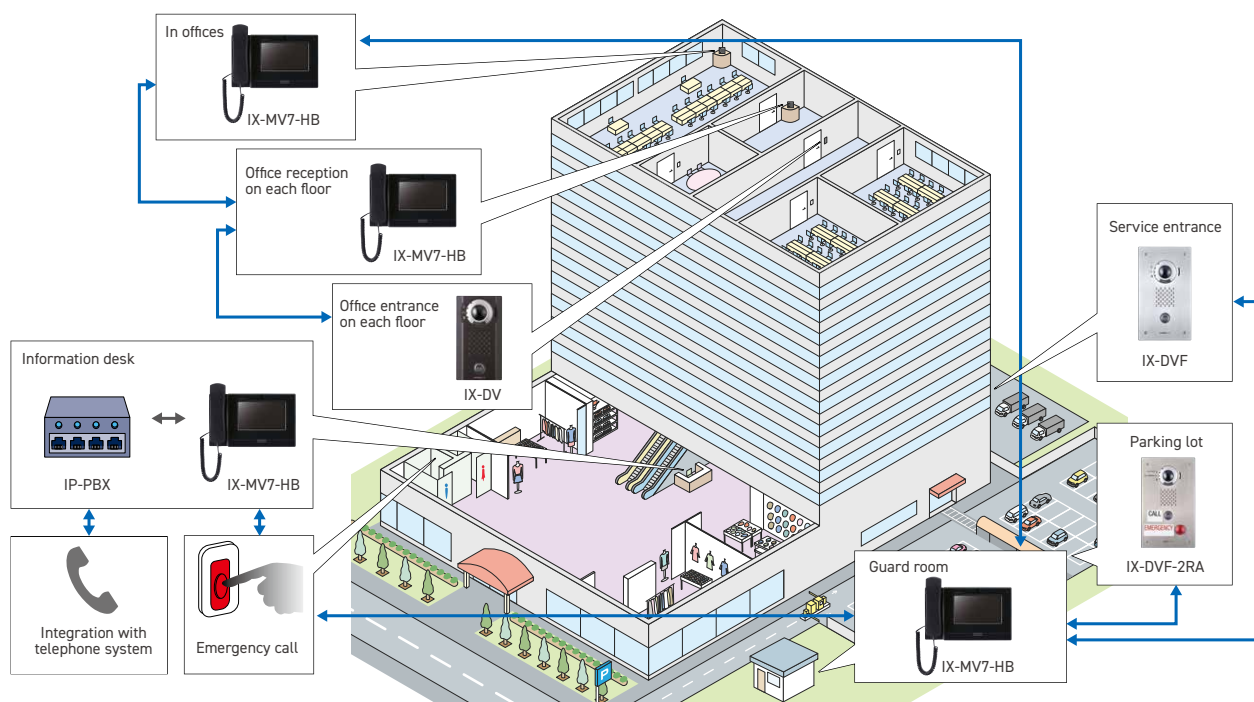

The IX system allows mutual communication between commercial facilities and offices combining emergency assistance functionality at parking areas and toilets. All-in-one system configuration also enables support for outside lines.

## Railways

All-in-one system for help points, communication between remote stations, and video surveillance

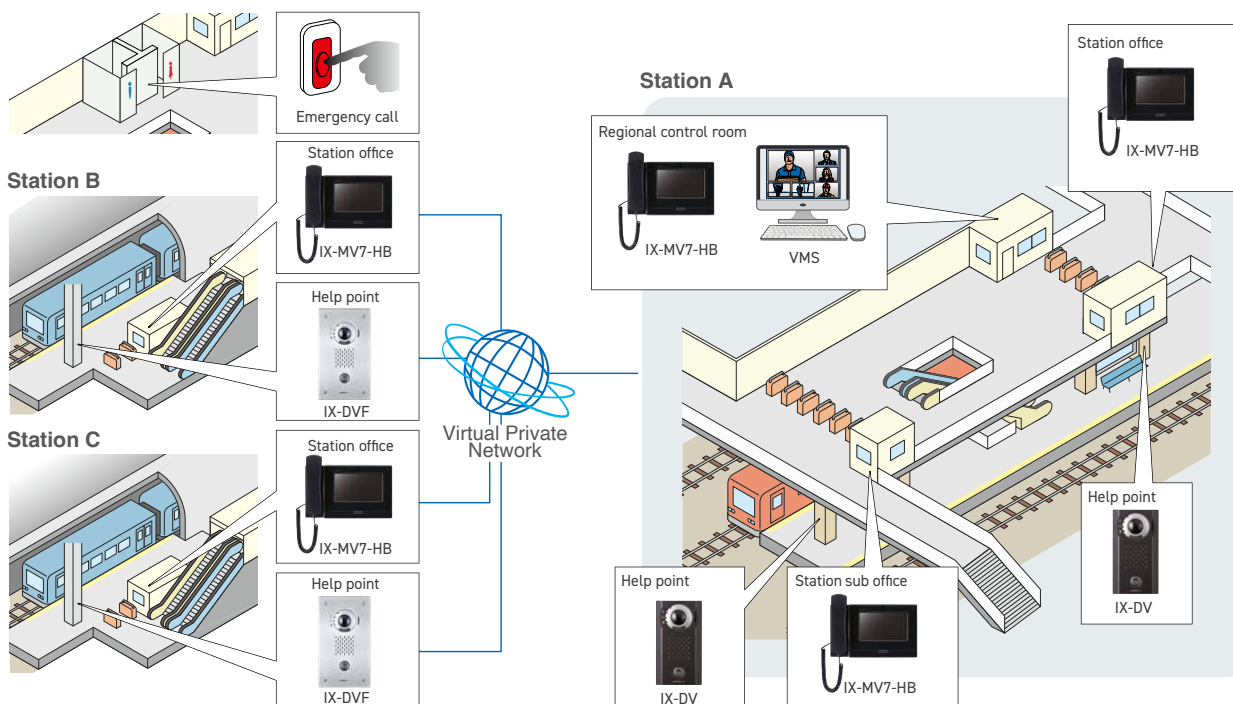

Respond to calls and queries from ticket machines, ticket gates, and platforms with video monitoring. Communication between remote stations is also possible.

## Schools

All-in-one system for door entry management, call transfer for after hours, and emergency paging

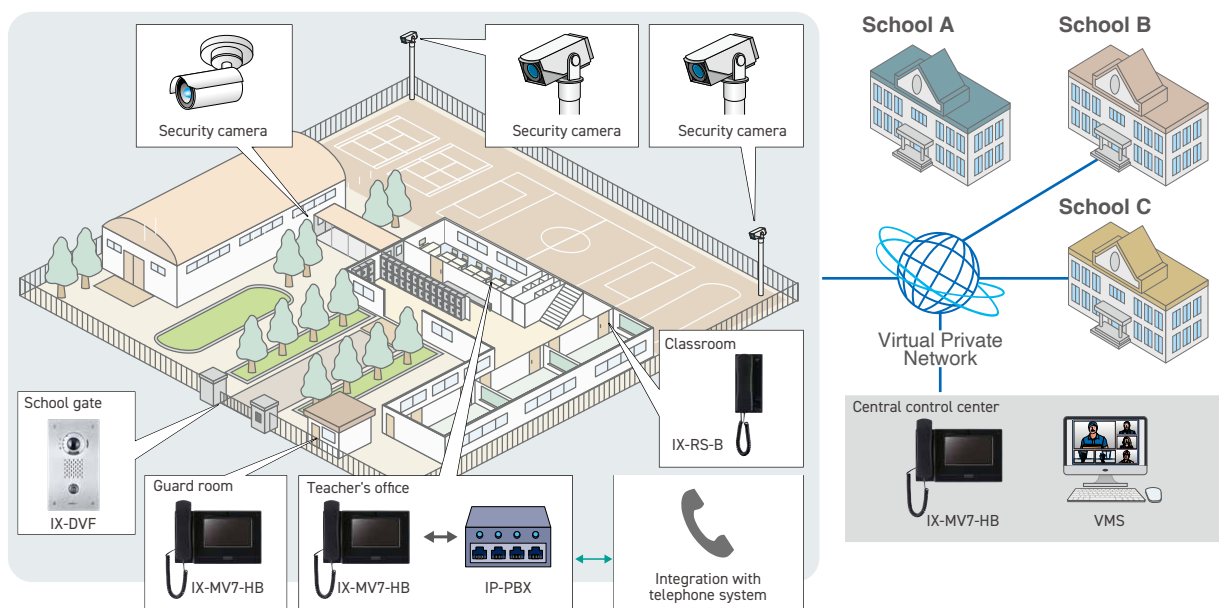

Management of entry and exit points integrated with access control can be accomplished. The system can also be used to enable teachers and staff members to easily communicate with one another. After hours control for schools within the district can be performed at a central control site. Use handset sub stations for privacy inside classrooms.

## Parking facilities

All-in-one system for emergency call, remote control of distant parking lots, and video surveillance

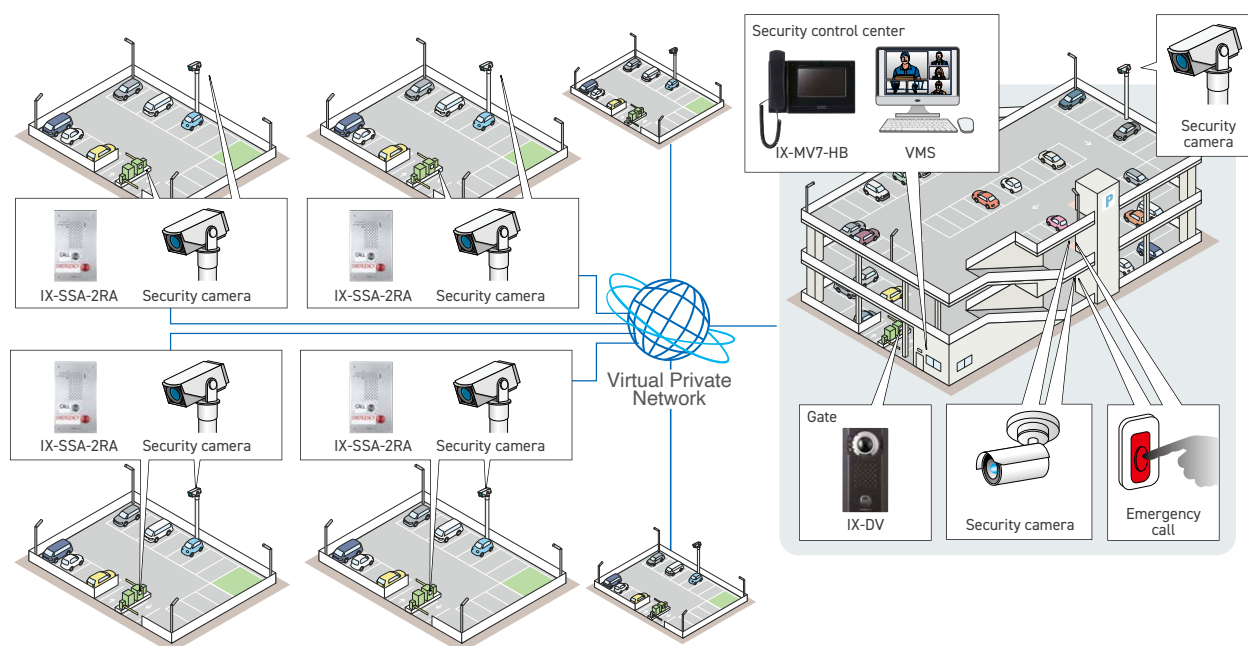

Audio communication and video identification allows for immediate response where assistance is needed. Crime prevention can be enhanced further through simultaneous installation of network cameras.



## System Configuration

## Virtual Private Network

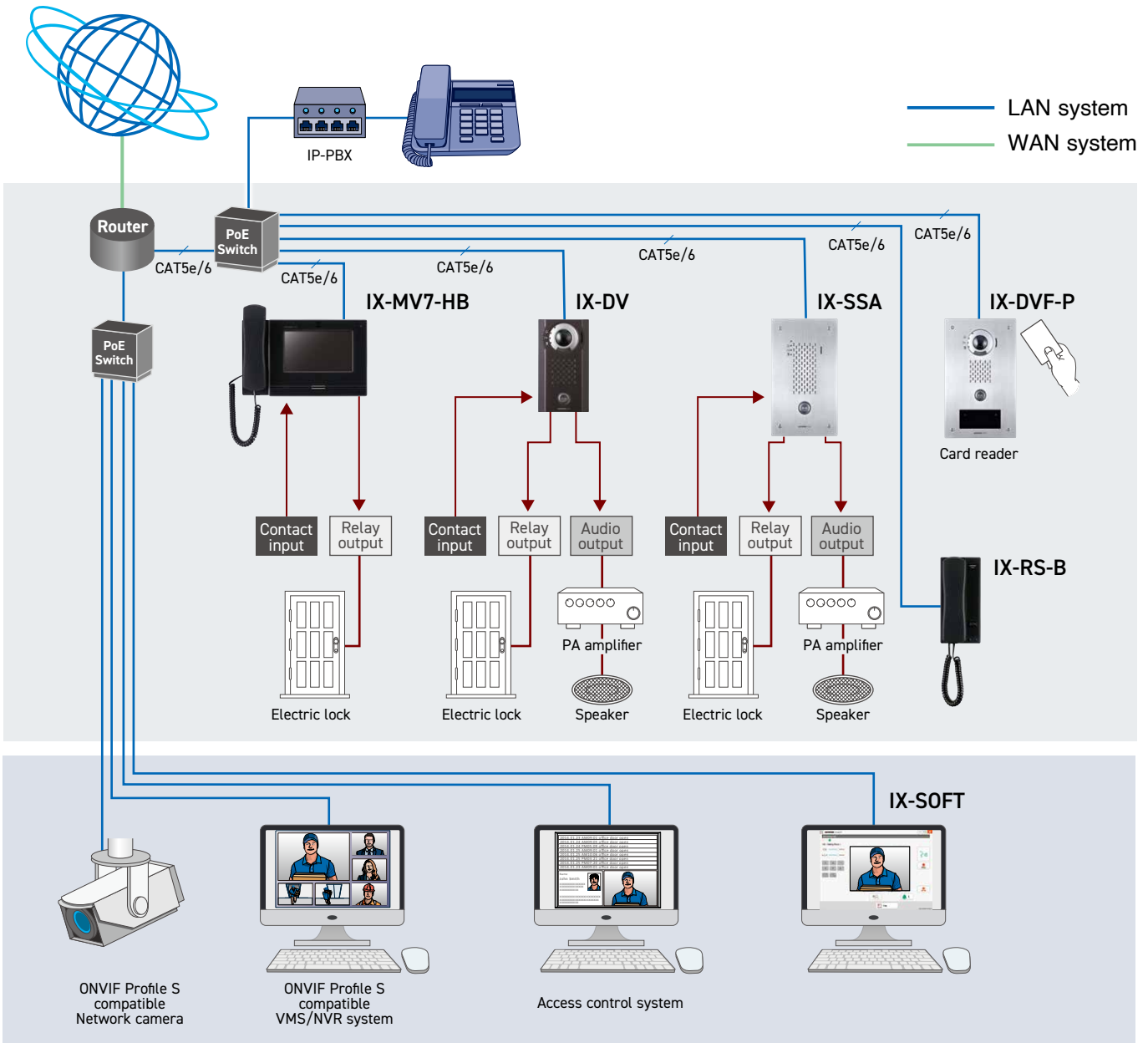

## Number of station registrations in address book

Product number	Product name	Number of station registrations in address book
IX-MV7-HB, IX-MV7-HW, IX-MV7-B, IX-MV7-W	Master Station	Expanded mode 9,998 stations
		Standard mode 500 stations
IX-SOFT	Intercom Application for PC	Expanded mode 9,998 stations
		Standard mode 499 stations
IX-RS-B, IX-RS-W	Handset Sub Station	20 stations* <sup>1</sup>
IX-DV, IX-DVF, IX-DVF-P, IX-DVF-RA, IX-DVF-2RA, IX-DVM, IX-EA, IX-DB	Video Door Station	20 stations* <sup>1</sup>
IX-SS-2G, IX-SSA, IX-SSA-RA, IX-SSA-2RA, IX-BB	Audio Only Door Station	20 stations* <sup>1</sup>

\*1. Master stations, sub stations, and intercom applications can be registered (Max. 20).

# System Components

## Master station



**IX-MV7-HB**  
IP Audio and video master station (Black)  
• UL listed: UL 62368-1



**IX-MV7-HW**  
(Color variation White)  
• UL listed: UL 62368-1



**IX-MV7-B**  
IP Audio and video master station (Black)  
• UL listed: UL 62368-1



**IX-MV7-W**  
(Color variation White)  
• UL listed: UL 62368-1

## Specifications

Power source	Power-over-Ethernet (IEEE 802.3af Class 0)
Type of communication	Hands-free : Automatic voice switching/touch-to-talk Handset : Full-duplex (for calls between handsets only) (IX-MV7-HB, IX-MV7-HW)
Monitor	7 inch TFT color LCD, WVGA 800 x 480
Camera	1/4-type CMOS, VGA 640 x 480
Input/Output	Contact input x 4, Relay output x 2, External speaker output x 1 Paging input x 1, Voice input/output x 1
Operating ambient temperature	0 - + 40 °C
Mounting	Desktop use (with desktop stand) or wall-mount
Material	Flame resistant PC + ABS resin

## Unit dimensions

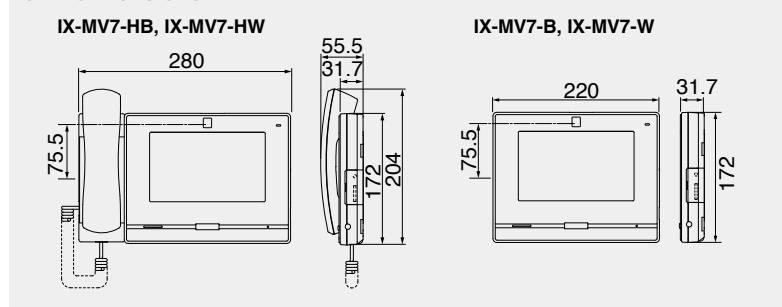

## Intercom application for PC



**IX-SOFT**  
IX Intercom application for PC<sup>\*1</sup>



License authentication  
USB dongle<sup>\*2</sup>

<sup>\*1</sup>. Download the software from our website (<https://www.aiphone.net/>) to the PC.  
<sup>\*2</sup>. USB dongle must be connected to PC with using software.

## System requirements

OS	Windows 7 Professional, Windows 7 Enterprise, Windows 7 Ultimate, Windows 8.1, Windows 8.1 Pro, Windows 8.1 Enterprise, Windows 10 Home, Windows 10 Pro, Windows 10 Enterprise, Windows 10 Education, Windows 11 Home, Windows 11 Pro, Windows 11 Enterprise
CPU	32 bit (x86) processor or 64 bit (x64) processor of 2 GHz or higher (Windows 7 is 64bit only)
Memory	1 GB or more
Screen resolution	1024 x 768 or greater
Runtime	.NET Framework 4.6.2 or later (Windows 7 requires SP1) Microsoft® Visual C ++ Redistributable Package for Visual Studio 2017 or later

\* When using Windows 7, the sound during the communication may be interrupted.

\* Microsoft and Windows are either registered trademarks or trademarks of Microsoft Corporation in the United States and/or other countries.

## Handset sub station



**IX-RS-B**  
IP Audio sub station (Black)  
• UL listed: UL 62368-1



**IX-RS-W**  
(Color variation White)  
• UL listed: UL 62368-1

## Specifications

Power source	Power-over-Ethernet (IEEE 802.3af Class 0)
Type of communication	Handset: Full-duplex (for calls between handsets only) Hands-free: Automatic voice switching
Input/Output	Contact input x 1, Relay output x 1, External speaker output x 1
Operating ambient temperature	0 - + 40 °C
Mounting	Surface wall-mount
Material	Flame resistant PC + ABS resin

## Unit dimensions

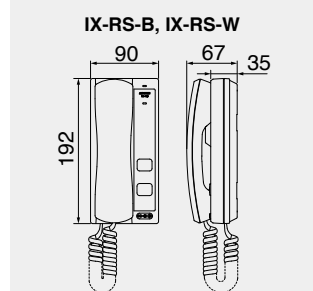



## Video door station



**IX-DV**  
IP Audio and video door station

- UL listed: UL 62368-1



**IX-DVF**  
IP Audio and video door station

- Mounting box included
- UL listed: UL 62368-1



**IX-DVF-P**  
IP Audio and video door station

- Same features as IX-DVF
- Compatible with Non-touch key reader (HID multi CLASS)
- \*Non-touch key reader not included



**IX-EA**  
IP Audio and video door station



**IX-DB**  
IP Audio and video door station

### Specifications

Power source	IX-DV, IX-DVF, IX-DVF-P: Power-over-Ethernet (IEEE 802.3af/at Class 4) or PS-2420S/UL/BF/DM/-0 IX-EA, IX-DB: Power-over-Ethernet (IEEE 802.3af Class 0)
Type of communication	Hands-free: automatic voice switching
Camera	IX-DV, IX-DVF, IX-DVF-P, IX-EA: 1/3-type color CMOS, SXVGA 1280 x 960 IX-DB: 1/3.2-type color CMOS
Minimum illumination	5 lux
Input/Output	IX-DV, IX-DVF, IX-DVF-P: Contact input x 6, Relay output x 2, Audio output x 1 IX-EA, IX-DB: Contact input x 1, Relay output x 1, Audio output x 1
Operating ambient temperature	IX-DV, IX-DVF, IX-DVF-P: -40 - + 60 °C IX-EA, IX-DB: -10 - + 60 °C
Mounting	IX-DV, IX-EA, IX-DB: Surface wall-mount IX-DVF, IX-DVF-P: Flush wall-mount
Material	Front panel IX-DV: Die-cast aluminum IX-DVF, IX-DVF-P: Stainless steel IX-EA: Fire-retardant ABS resin IX-DB: Fire-retardant ABS plastic

### Unit dimensions

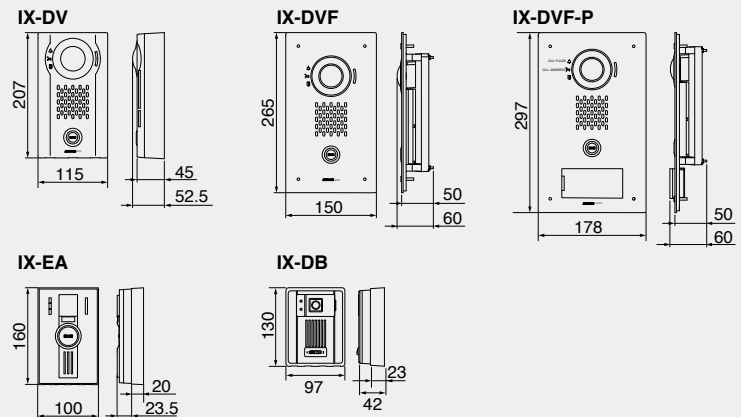

## Video door station (Mullion and contactless call sensor model)



**IX-DVM**  
IP Audio and video door station

- With contactless call sensor
- UL listed: UL 62368-1

\*Sales may be limited in certain countries and locations due to government regulations and requirements. Please contact your AIPHONE distributors for more details.

### Specifications

Power source	Power-over-Ethernet (IEEE 802.3af Class 0)
Type of communication	Hands-free: automatic voice switching
Camera	1/3.8-type color CMOS, HD 1280 x 720
Minimum illumination	5 lux
Input/Output	Contact input x 1, Relay output x 1
Operating ambient temperature	-40 - + 60 °C
Mounting	Surface wall-mount
Material	Unit: Die-cast aluminum
Remarks	This product incorporates a Class 1 laser. Laser emissions conform with IEC 60825-1:2014.

### Unit dimensions

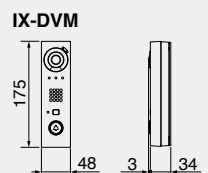

## Video door station (Emergency call button and braille models)



**IX-DVF-RA**  
IP Audio and video door station

- Mounting box included
- No call button
- With emergency call button and braille (English braille)
- UL listed: UL 62368-1



**IX-DVF-2RA**  
IP Audio and video door station

- Mounting box included
- With call button and braille (English braille)
- With emergency call button and braille (English braille)
- UL listed: UL 62368-1

### Specifications

Power source	Power-over-Ethernet (IEEE 802.3af/at Class 4) or PS-2420S/UL/BF/DM/-0
Type of communication	Hands-free: automatic voice switching
Camera	1/3-type color CMOS, SXVGA 1280 x 960
Minimum illumination	5 lux
Input/Output	Contact input x 5, Relay output x 2, Audio output x 1
Operating ambient temperature	-40 - + 60 °C
Mounting	Flush wall-mount
Material	Front panel: Stainless steel

### Unit dimensions

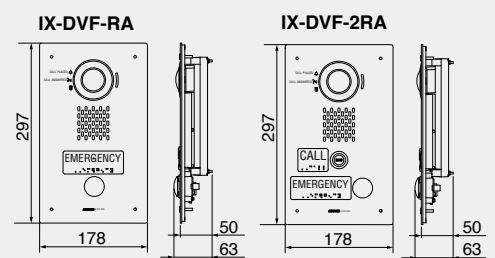

## Audio door station



**IX-SSA**  
IP Audio door station

- Mounting box included
- UL listed: UL 62368-1



**IX-SS-2G**  
IP Audio door station

- UL listed: UL 62368-1



**IX-BB**  
IP Audio door station

### Specifications

<b>Power source</b>	IX-SSA: Power-over-Ethernet (IEEE 802.3af/at Class 4) or PS-2420S/UL/BF/DM/-O IX-SS-2G, IX-BB: Power-over-Ethernet (IEEE 802.3af class 0)
<b>Type of communication</b>	Hands-free: automatic voice switching
<b>Input/Output</b>	IX-SSA: Contact input x 6, Relay output x 2, Audio output x 1 IX-SS-2G: Contact input x 1, Relay output x 1 IX-BB: Contact input x 1, Relay output x 1, Audio output x 1
<b>Operating ambient temperature</b>	IX-SSA, IX-SS-2G: -40 - + 60 °C IX-BB: -10 - + 60 °C
<b>Mounting</b>	IX-SSA, IX-SS-2G: Flush wall-mount, IX-BB: Surface wall-mount
<b>Material</b>	Front panel IX-SSA, IX-SS-2G: Stainless steel, IX-BB: Fire-retardant ABS plastic

### Unit dimensions

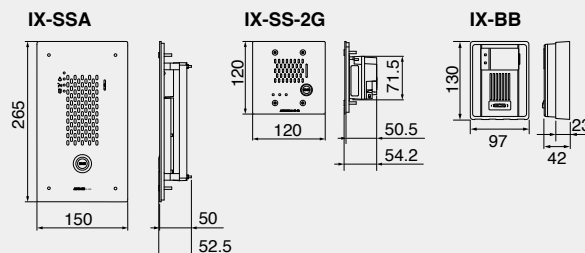

## Audio door station (Emergency call button and braille models)



**IX-SSA-RA**  
IP Audio door station

- Mounting box included
- No call button
- With emergency call button and braille (English braille)
- UL listed: UL 62368-1



**IX-SSA-2RA**  
IP Audio door station

- Mounting box included
- With call button and braille (English braille)
- With emergency call button and braille (English braille)
- UL listed: UL 62368-1

### Specifications

<b>Power source</b>	Power-over-Ethernet (IEEE 802.3af/at Class 4) or PS-2420S/UL/BF/DM/-O
<b>Type of communication</b>	Hands-free: automatic voice switching
<b>Input/Output</b>	Contact input x 5, Relay output x 2, Audio output x 1
<b>Operating ambient temperature</b>	-40 - + 60 °C
<b>Mounting</b>	Flush wall-mount
<b>Material</b>	Front panel: Stainless steel

### Unit dimensions

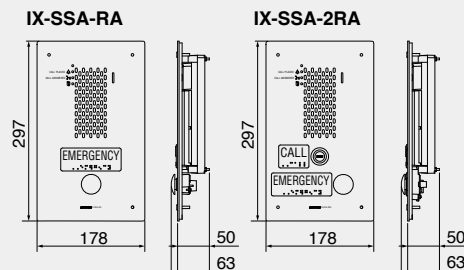

## Multi-purpose adaptor



**IXW-MA**  
Multi-purpose adaptor

- Link to various devices to allow two way control

### Specifications

<b>Power source</b>	Power-over-Ethernet (IEEE 802.3af Class 0)
<b>Input/Output</b>	Contact input x 4, Relay output x 10
<b>Operating ambient temperature</b>	-10 - + 50 °C
<b>Mounting</b>	Wall-mount
<b>Material</b>	Self-extinguishing PC + ABS resin

### Unit dimensions

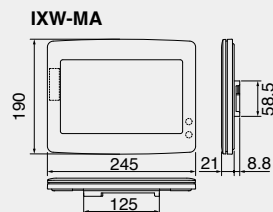

.....Dust and moisture resistant



.....Ruggedized against vandalism



.....STAINLESS STEEL material





Distributed by :



IX(E) 2nd. April 2025



All rights reserved. All statements valid at time of printing. The design and specifications are subject to change without notice for improvement.

QB67025AWZ